



FILED

1-28-16
04:59 PM

Exhibit B

Project Drawings

A1601013

Exhibit B4 – Guideway Drawings

Exhibit B4-1 – Track Charts

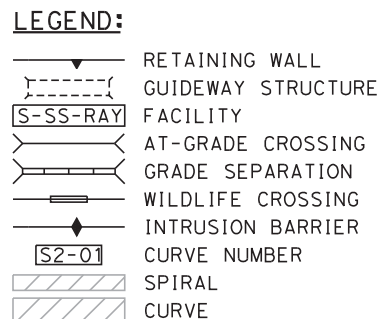

CALIFORNIA
HIGH-SPEED RAIL AUTHORITY

\$DOCUMENT_FULLNAME\$ 10/20/2015 4:44:28 PM CHSTP.TB1 CHSR_PDF_half_black.plt c:\pwworking\acdot\p004863a\dms07895\TT-E6004B.dgn

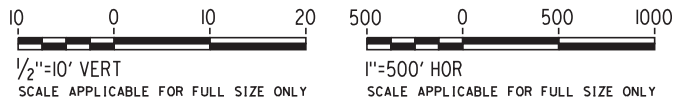

ALIGNMENT

NOTE:

INFORMATION SHOWN ON TRACKCHART OTHER THAN TRACKWORK SHALL BE USED AS GUIDANCE, AND IS FOR INFORMATION ONLY.

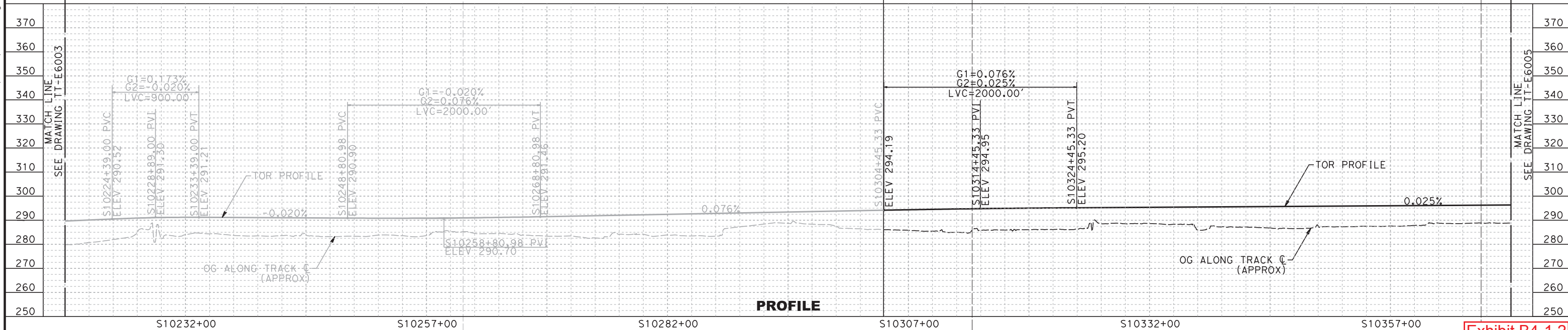
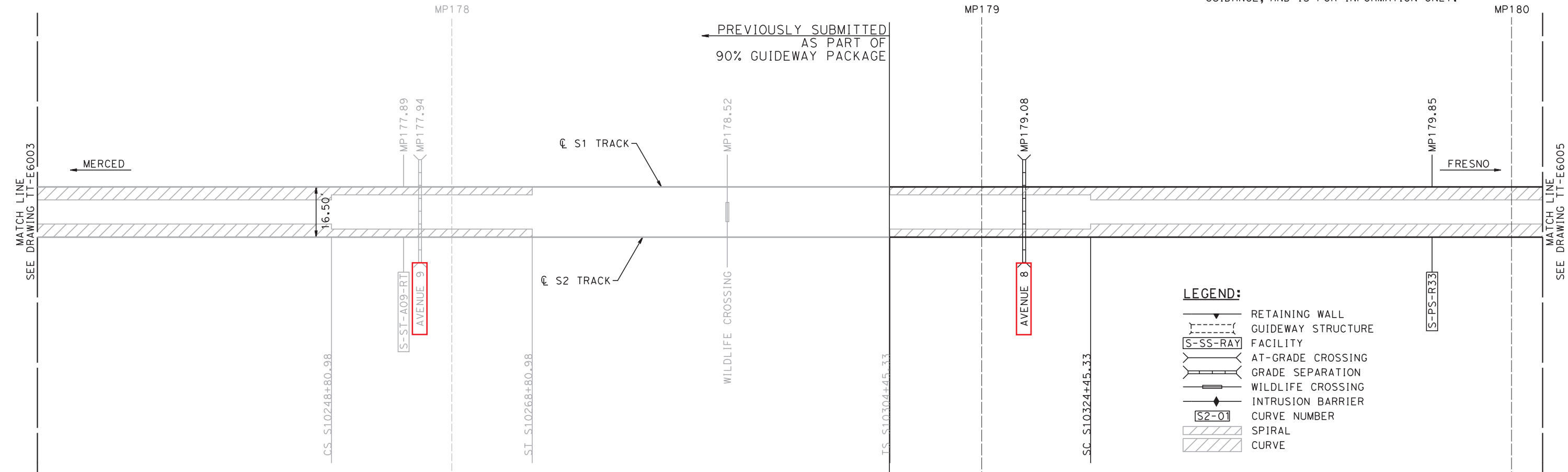

REV	DATE	BY	CHK	APP	DESCRIPTION
B	11/03/15				90% GUIDEWAY STA 10304+00.00 TO 10691+50.00
A	10/24/14				60% GUIDEWAY STA 10304+00.00 TO 10691+50.00

DESIGNED BY A. SOBOLEWSKA
DRAWN BY A. SOBOLEWSKA
CHECKED BY A. FERNANDEZ
IN CHARGE S. GOOLLA
DATE 11/03/2015

90% SUBMITTAL
NOT FOR CONSTRUCTION

CALIFORNIA HIGH-SPEED TRAIN PROJECT CP-1 AGREEMENT NO.4 HSR13-06 SUBMITTAL REVIEW IN ACCORDANCE WITH BOOK 2, PART B - GENERAL PROVISIONS - SECTION 61.2
APPROVED
SIGNED _____
DATE _____



CALIFORNIA HIGH-SPEED TRAIN PROJECT CONSTRUCTION PACKAGE 1	CONTRACT NO. HSR13-06
TRACK CHART SHEET 1 OF 4	DRAWING NO. TT-E6004B
	SCALE AS SHOWN
	SHEET NO.

Exhibit B4-1.2

1/25/2015 9:17:28 PM CHSTP.tbl CHSR_PDF_half_black.plt c:\pw_working\california\p005136a\dms07895\TT-E6004.dgn

p005136a

ALIGNMENT

NOTE:

INFORMATION SHOWN ON TRACKCHART OTHER THAN TRACKWORK SHALL BE USED AS GUIDANCE, AND IS FOR INFORMATION ONLY.

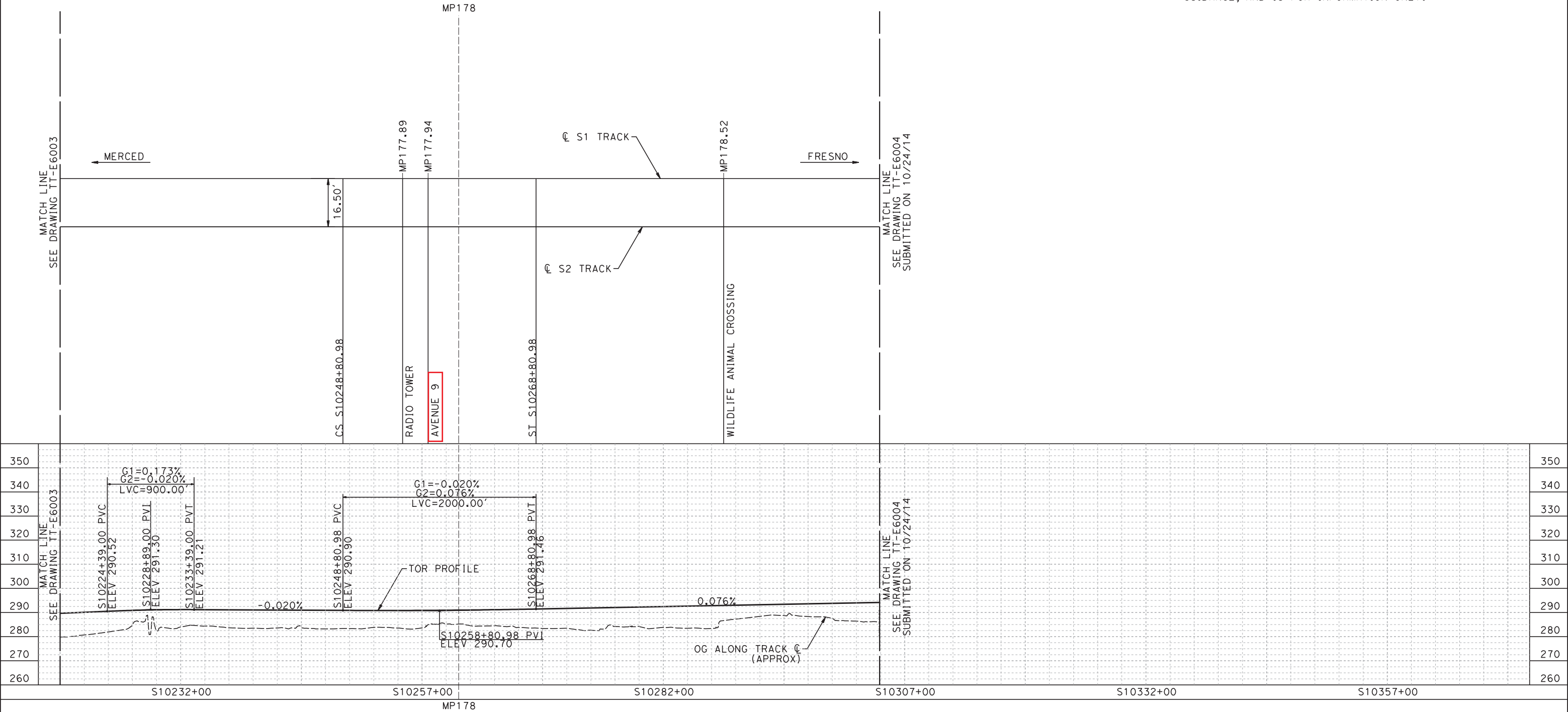

PROFILE

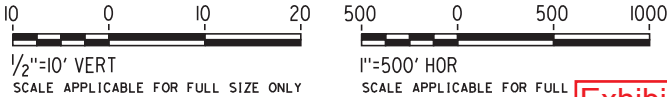

Exhibit B4-1.3

REV	DATE	BY	CHK	APP	DESCRIPTION
C	01/30/15				90% GUIDEWAY STA 9772+35.08 TO 10304+00.00
B	10/24/14				60% GUIDEWAY STA 10304+00.00 TO 10691+50.00
A	09/29/14				60% GUIDEWAY STA 9772+35.08 TO 10304+00.00

DESIGNED BY A. SOBOLEWSKA
DRAWN BY A. SOBOLEWSKA
CHECKED BY E. CASTELINO
IN CHARGE S. GOOLLA
DATE 01/30/2015

90% SUBMITTAL

NOT FOR CONSTRUCTION

CALIFORNIA HIGH-SPEED TRAIN PROJECT
CONSTRUCTION PACKAGE 1

TRACK CHART
SHEET 4 OF 4

CONTRACT NO. HSR13-06
DRAWING NO. TT-E6004
SCALE AS SHOWN
SHEET NO.

p005136a 1/25/2015 9:16:58 PM CHSTP.tbl CHSR_PDF_half_black.plt c:\pw_working\california\p005136a\dms07895\TT-E6003.dgn

NOTE:

INFORMATION SHOWN ON TRACKCHART OTHER THAN TRACKWORK SHALL BE USED AS GUIDANCE, AND IS FOR INFORMATION ONLY.

ALIGNMENT

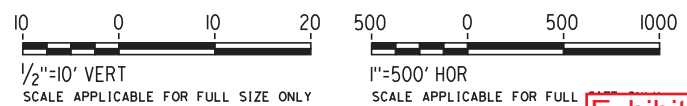
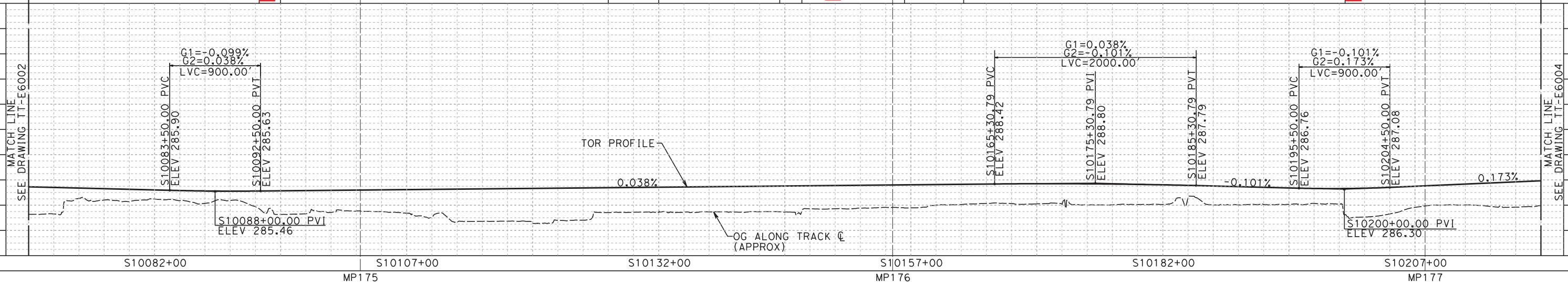
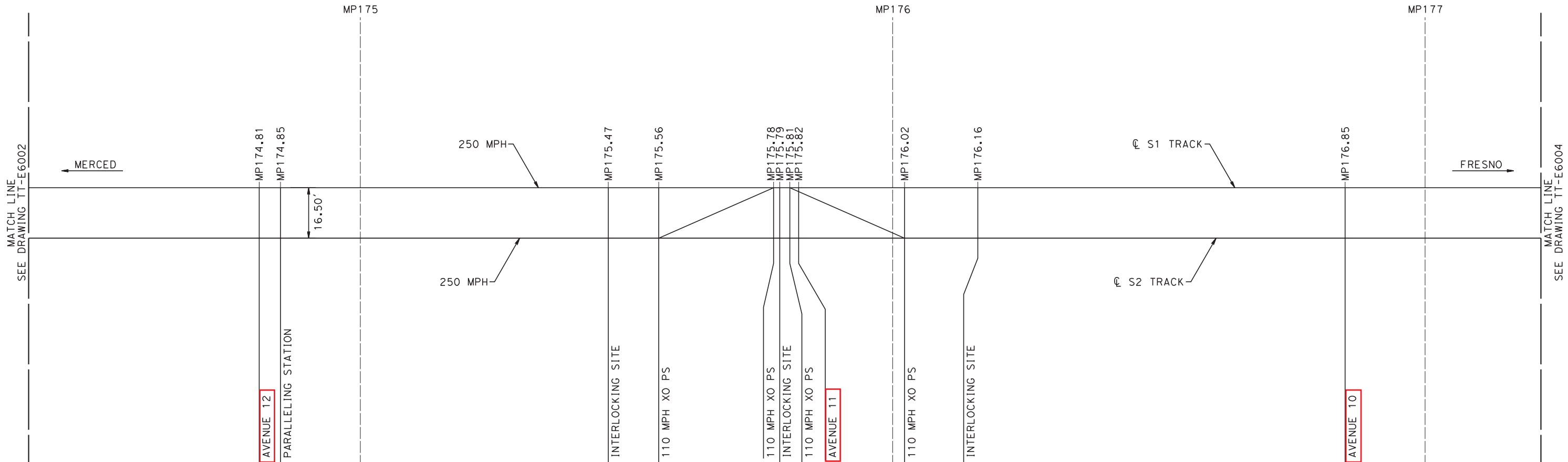

Exhibit B4-1.4

REV	DATE	BY	CHK	APP	DESCRIPTION
B	01/30/15				60% GUIDEWAY STA 9772+35.08 TO 10304+00.00
A	09/29/14				60% GUIDEWAY STA 9772+35.08 TO 10304+00.00

DESIGNED BY A. SOBOLEWSKA
DRAWN BY A. SOBOLEWSKA
CHECKED BY E. CASTELINO
IN CHARGE S. GOOLLA
DATE 01/30/2015

90% SUBMITTAL

NOT FOR
CONSTRUCTION



CALIFORNIA HIGH-SPEED TRAIN PROJECT
CONSTRUCTION PACKAGE 1

TRACK CHART
SHEET 3 OF 4

CONTRACT NO. HSR13-06
DRAWING NO. TT-E6003
SCALE AS SHOWN
SHEET NO.

Exhibit B

Project Drawings

Exhibit B4 – Guideway Drawings

Exhibit B4-2 – Track Typical Cross Sections

→ STA S9892+35.00 TO STA S9987+43.45
STA S10145+46.22 TO STA S10146+70.23
STA S10154+07.70 TO STA S10165+30.79
STA S10268+80.98 TO STA S10284+47.35
STA S10287+79.32 TO STA S10304+00.00

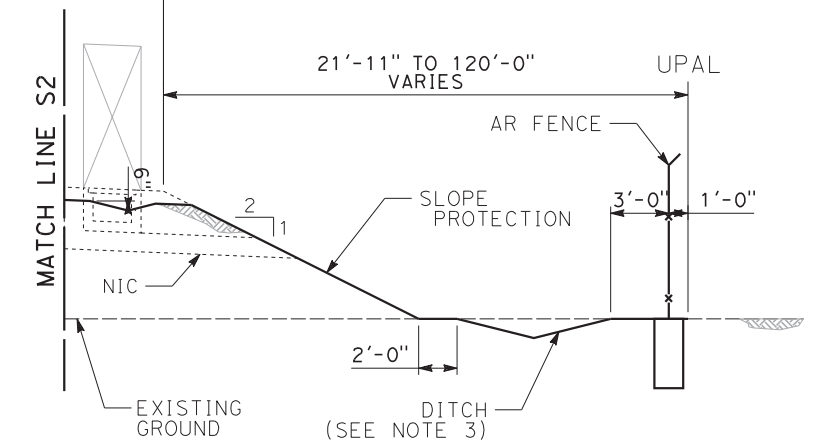
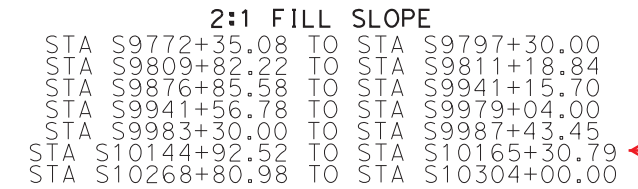

STA S9772+35.08 TO STA S9813+72.64
STA S9876+85.58 TO STA S9987+43.45
→ STA S10144+92.52 TO STA S10165+30.79
STA S10268+80.98 TO STA S10304+00.00

2:1 FILL SLOPE w/ SOUNDWALL
STA S9772+35.08 TO STA S9805+20.00

1. ALL SYSTEMS AND TRACK WORK TO BE CONSTRUCTED BY OTHERS.
2. CP CONTROLS BOTH HORIZONTAL AND VERTICAL ALIGNMENT.
3. SEE DRAINAGE DRAWINGS FOR DITCH DETAILS.
4. THE CONTROL POINT (CP) IS THE INTERSECTION OF THE CENTERLINE OF TRACK AND THE TOP OF RAIL. FOR SUPERELEVATED TRACK SECTIONS THE CP IS THE INTERSECTION OF $\frac{1}{2}$ OF TRACK AND THE TOP OF LOW RAIL.
5. FOR FINAL DIMENSIONS OF PREPARED SUBGRADE SEE GEOTECHNICAL REPORT.
6. FOR RETAINING WALL LAYOUT SEE RETAINING WALL SHEETS.
7. FOR DRAINAGE MATERIAL AND RIP RAP PROTECTION SEE DRAWING NO. TT-Y8002.
8. THE TOP OF CUT SLOPES, OTHER THAN THOSE IN ROCK, SHALL BE ROUNDED BETWEEN POINTS A MINIMUM 2 FEET ON BOTH SIDES OF THE INTERSECTION OF THE SLOPE PLANES.

						DESIGNED BY A. FERNANDEZ
D	01/30/15				90% GUIDEWAY STA 9772+35.08 TO 10304+00.00	DRAWN BY A. FERNANDEZ
C	09/29/14				60% GUIDEWAY STA 9772+35.08 TO 10304+00.00	CHECKED BY E. CASTELINO
B	07/11/14				DESIGN BASELINE REPORT	IN CHARGE S. GOOLLA
A	06/23/14				DESIGN BASELINE REPORT	DATE 01/30/2015
REV	DATE	BY	CHK	APP	DESCRIPTION	

**NOT FOR
CONSTRUCTION**

ZACHRY

A joint venture



TRACK TYPICAL SECTION
SHEET 1 OF 11

CONTRACT NO. HSR13-06
DRAWING NO. TT-D3001
SCALE 1" = 5'
SHEET NO. 1 OF 11

1/30/2015 11:17:32 AM CHSTP.tbl CHSR_PDF_half_black.plt c:\pwworking\california\p005251a\dms07895\TT-D3004.dgn

2:1 FILL SLOPE
STA S9842+83.25 TO STA S9855+34.93
STA S9875+00.00 TO STA S9876+06.00
STA S9987+43.45 TO STA S10001+42.88
STA S10003+99.08 TO STA S10025+93.49
STA S10029+71.86 TO STA S10059+75.42
STA S10069+37.98 TO STA S10095+40.00
STA S10165+30.79 TO STA S10200+00.28
STA S10206+99.25 TO STA S10215+58.80
STA S10222+31.91 TO STA S10268+80.98

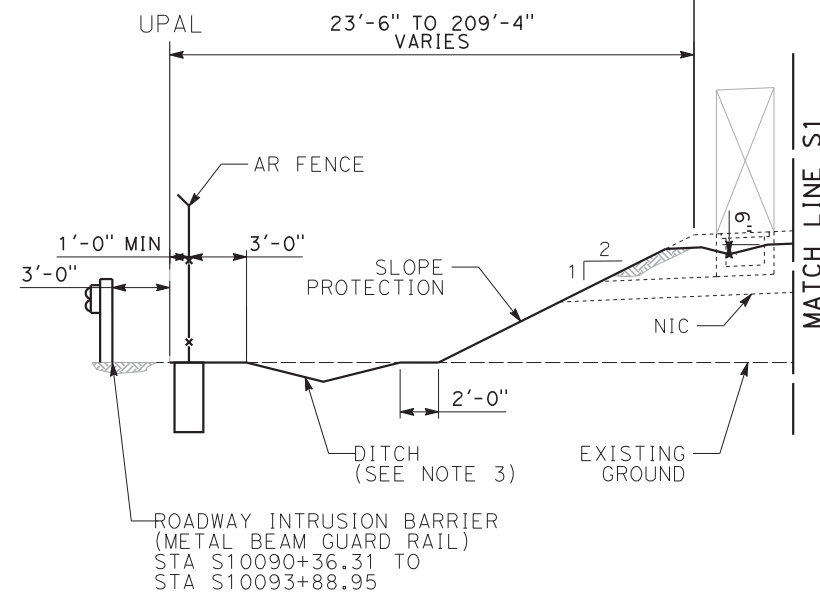

NOTE:

1. ALL SYSTEMS AND TRACK WORK TO BE CONSTRUCTED BY OTHERS.
2. CP CONTROLS BOTH HORIZONTAL AND VERTICAL ALIGNMENT.
3. SEE DRAINAGE DRAWINGS FOR DITCH DETAILS.
4. THE CONTROL POINT (CP) IS THE INTERSECTION OF THE CENTERLINE OF TRACK AND THE TOP OF RAIL. FOR SUPERELEVATED TRACK SECTIONS THE CP IS THE INTERSECTION OF ϕ OF TRACK AND THE TOP OF LOW RAIL.
5. FOR FINAL DIMENSIONS OF PREPARED SUBGRADE SEE GEOTECHNICAL REPORT.
6. FOR RETAINING WALL LAYOUT SEE RETAINING WALL SHEETS.
7. FOR DRAINAGE MATERIAL AND RIP RAP PROTECTION SEE DRAWING NO. TT-Y8002.
8. THE TOP OF CUT SLOPES, OTHER THAN THOSE IN ROCK, SHALL BE ROUNDED BETWEEN POINTS A MINIMUM 2 FEET ON BOTH SIDES OF THE INTERSECTION OF THE SLOPE PLANES.

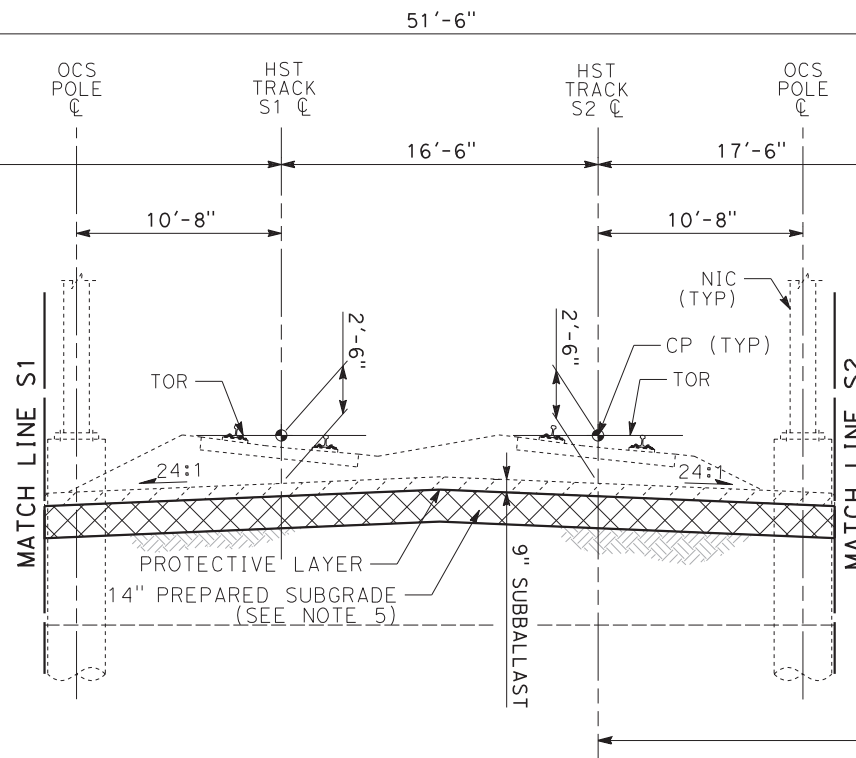

TYPICAL SECTION

TWO TRACKS - SUPERELEVATED

STA S9813+72.64 TO STA S9826+99.75
STA S9842+83.25 TO STA S9876+85.58
STA S9987+43.45 TO STA S10001+42.88
STA S10003+99.08 TO STA S10025+98.49
STA S10029+71.86 TO STA S10096+61.28
STA S10165+30.79 TO STA S10200+28.93
STA S10202+04.05 TO STA S10268+80.98

Avenue 12 - Station 10091+90.91
Avenue 10 - Station 10200+11.89
Avenue 9 - Station 10257+67.03

2:1 FILL SLOPE
STA S9866+35.00 TO STA S9876+85.58
STA S9987+43.45 TO STA S10001+42.88
STA S10003+99.08 TO STA S10025+93.49
STA S10029+71.86 TO STA S10055+51.88
STA S10072+85.13 TO STA S10096+61.28
STA S10165+30.79 TO STA S10200+28.93
STA S10202+04.05 TO STA S10268+80.98

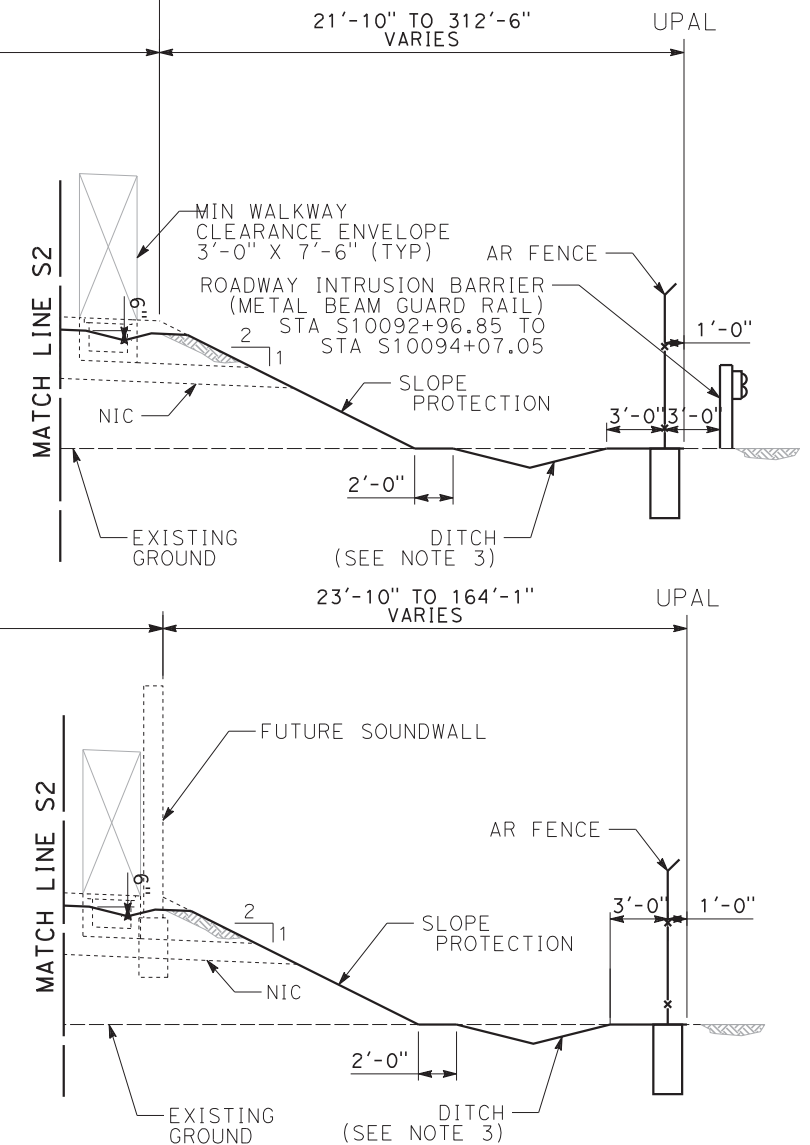

2:1 FILL SLOPE w/ SOUNDWALL

STA S9843+29.52 TO STA S9845+73.68
STA S9850+75.00 TO STA S9858+22.64
STA S9861+86.00 TO STA S9862+42.30
STA S9865+55.00 TO STA S9866+35.00

REV	DATE	BY	CHK	APP	DESCRIPTION
D	01/30/15				90% GUIDEWAY STA 9772+35.08 TO 10304+00.00
C	09/29/14				60% GUIDEWAY STA 9772+35.08 TO 10304+00.00
B	07/11/14				DESIGN BASELINE REPORT
A	06/23/14				DESIGN BASELINE REPORT

DESIGNED BY A. FERNANDEZ
DRAWN BY A. FERNANDEZ
CHECKED BY E. CASTELINO
IN CHARGE S. GOOLLA
DATE 01/30/2015

90% SUBMITTAL

NOT FOR
CONSTRUCTION

TutorPerini

ZACHRY

PARSONS
A joint venture



CALIFORNIA
HIGH-SPEED RAIL AUTHORITY

**CALIFORNIA HIGH-SPEED TRAIN PROJECT
CONSTRUCTION PACKAGE 1**

TRACK TYPICAL SECTION
SHEET 4 OF 11

Exhibit B4-2.2

CONTRACT NO. HSR13-06
DRAWING NO. TT-D3004
SCALE 1" = 5'
SHEET NO. 4 OF 11

CHSR_PDF_half_black.plt:ctb:pw_working\california\p005136a\dms07895\TT-D3005.dgn
1/26/2015 12:36:56 PM CHSTP.tbl
P005136A

1:1 FILL SLOPE
→ STA S10059+75.42 TO STA S10069+37.98
STA S10200+00.28 TO STA S10200+28.93
STA S10202+04.05 TO STA S10206+99.25
STA S10215+58.80 TO STA S10222+31.91

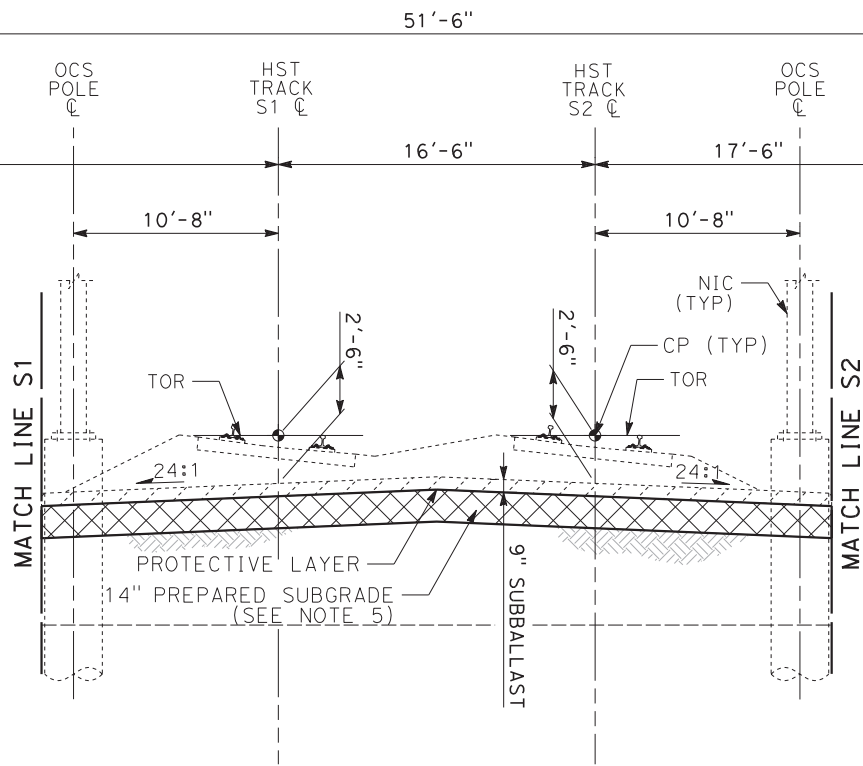
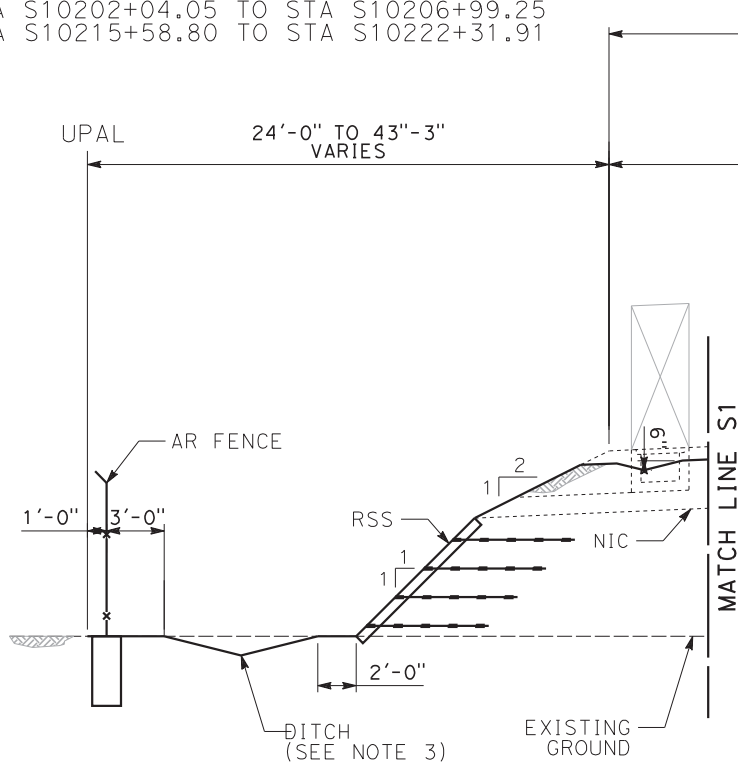

1:1 FILL SLOPE
STA S10055+51.88 TO STA S10072+85.13

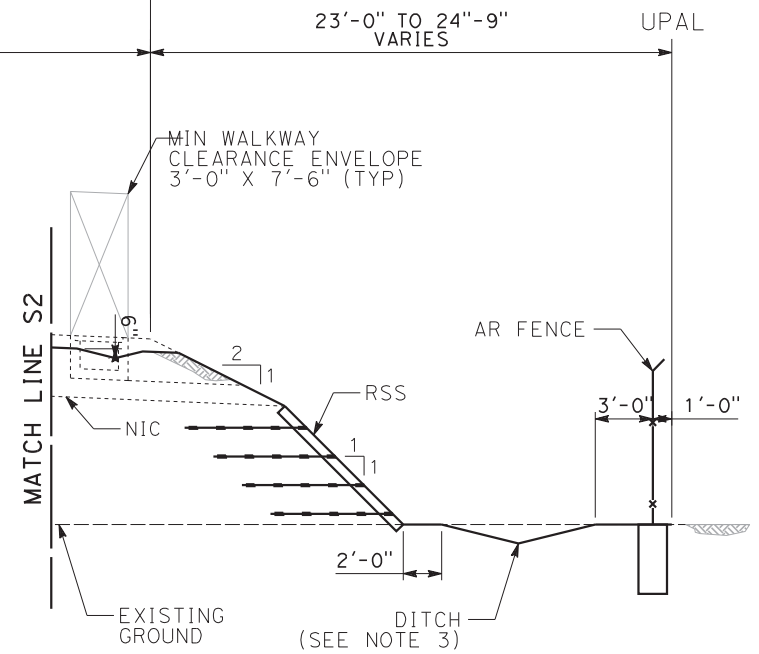

TYPICAL SECTION TWO TRACKS - SUPERELEVATED

→ STA S9813+72.64 TO STA S9826+99.75
STA S9842+83.25 TO STA S9876+85.58
STA S9987+43.45 TO STA S10001+42.88
STA S10003+99.08 TO STA S10025+93.49
STA S10029+71.86 TO STA S10096+61.28
→ STA S10165+30.79 TO STA S10200+28.93
STA S10202+04.05 TO STA S10268+80.98

Avenue 10 - Station 10200+11.89

NOTE:

1. ALL SYSTEMS AND TRACK WORK TO BE CONSTRUCTED BY OTHERS.
2. CP CONTROLS BOTH HORIZONTAL AND VERTICAL ALIGNMENT.
3. SEE DRAINAGE DRAWINGS FOR DITCH DETAILS.
4. THE CONTROL POINT (CP) IS THE INTERSECTION OF THE CENTERLINE OF TRACK AND THE TOP OF RAIL. FOR SUPERELEVATED TRACK SECTIONS THE CP IS THE INTERSECTION OF \mathcal{C} OF TRACK AND THE TOP OF LOW RAIL.
5. FOR FINAL DIMENSIONS OF PREPARED SUBGRADE SEE GEOTECHNICAL REPORT.
6. FOR RETAINING WALL LAYOUT SEE RETAINING WALL SHEETS.
7. FOR DRAINAGE MATERIAL AND RIP RAP PROTECTION SEE DRAWING NO. TT-Y8002.
8. THE TOP OF CUT SLOPES, OTHER THAN THOSE IN ROCK, SHALL BE ROUNDED BETWEEN POINTS A MINIMUM 2 FEET ON BOTH SIDES OF THE INTERSECTION OF THE SLOPE PLANES.

Exhibit B4-2.3

REV	DATE	BY	CHK	APP	DESCRIPTION
C	01/30/15				90% GUIDEWAY STA 9772+35.08 TO 10304+00.00
B	09/29/14				60% GUIDEWAY STA 9772+35.08 TO 10304+00.00
A	06/23/14				DESIGN BASELINE REPORT

DESIGNED BY A. FERNANDEZ
DRAWN BY A. FERNANDEZ
CHECKED BY E. CASTELINO
IN CHARGE S. GOOLLA
DATE 01/30/2015

90% SUBMITTAL

NOT FOR
CONSTRUCTION

Tutor Perini

ZACHRY

PARSONS

A joint venture



CALIFORNIA
HIGH-SPEED RAIL AUTHORITY

CALIFORNIA HIGH-SPEED TRAIN PROJECT CONSTRUCTION PACKAGE 1

TRACK TYPICAL SECTION
SHEET 5 OF 11

CONTRACT NO. HSR13-06
DRAWING NO. TT-D3005
SCALE 1" = 5'
SHEET NO. 5 OF 11

\$DOCUMENT FULLNAME\$ 10/21/2015 3:13:03 PM CHSR_PDF_half_black.plt c:\pwworking\california\p005251a\dms07895\TT-D3008B.dgn

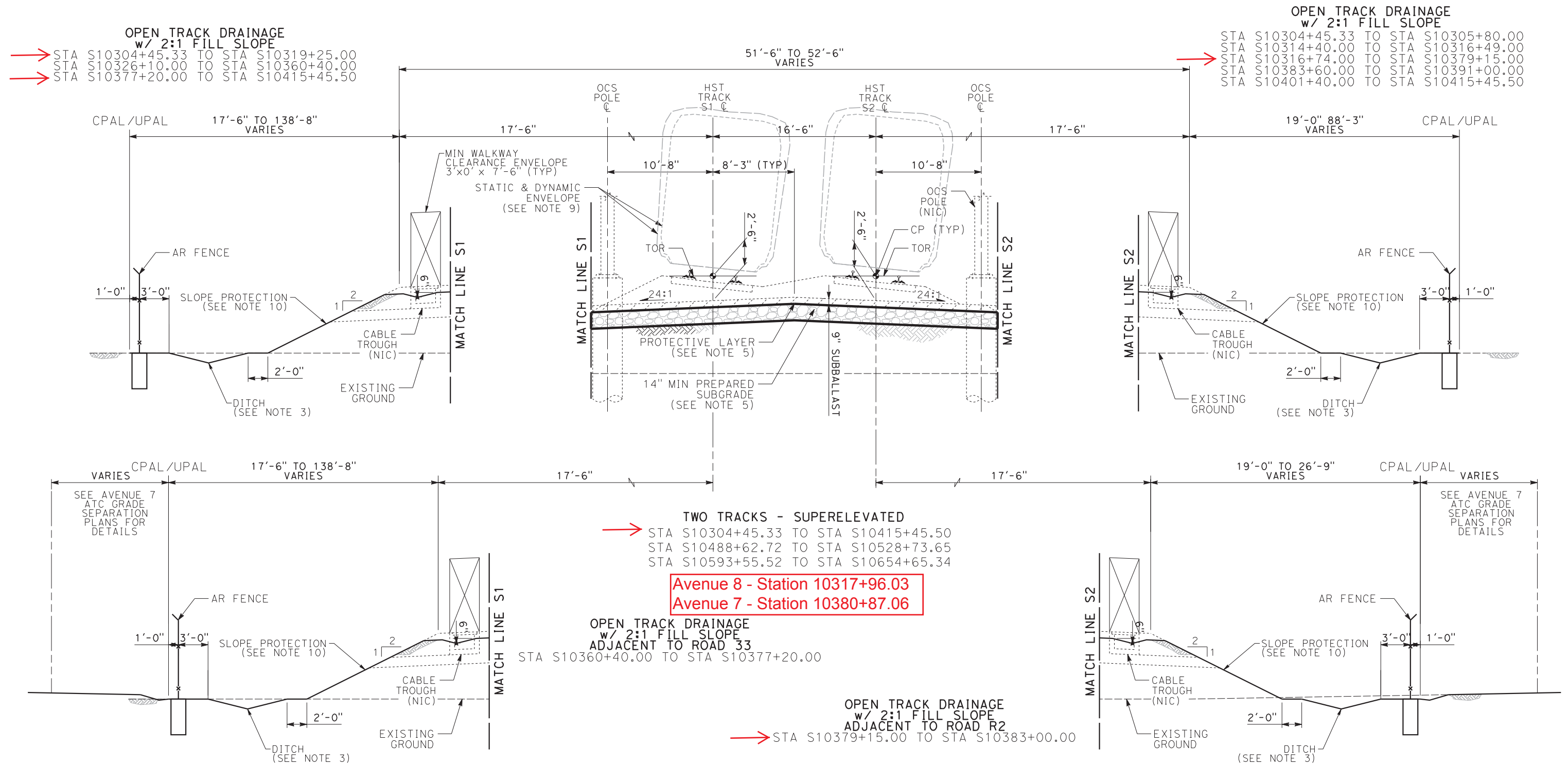

Exhibit B4-2.4

REV	DATE	BY	CHK	APP	DESCRIPTION
C	11/03/15				90% GUIDEWAY STA 10304+00 TO 10691+50
B	08/25/15				DESIGN BASELINE REPORT PART 5 REV 1
A	03/19/15				DBR PART 5 REV 0

DESIGNED BY A. SOBOLEWSKA
DRAWN BY A. SOBOLEWSKA
CHECKED BY A. FERNANDEZ
IN CHARGE S. GOOLLA
DATE 11/03/2015

90% SUBMITTAL

NOT FOR CONSTRUCTION

CALIFORNIA HIGH-SPEED TRAIN PROJECT CP-1 AGREEMENT NO.4 HSR13-06 SUBMITTAL REVIEW IN ACCORDANCE WITH BOOK 2, PART B - GENERAL PROVISIONS - SECTION 61.2
APPROVED
SIGNED _____
DATE _____



CALIFORNIA HIGH-SPEED TRAIN PROJECT
CONSTRUCTION PACKAGE 1
TRACK TYPICAL SECTION
SHEET 8 OF 12

CONTRACT NO. HSR13-06
DRAWING NO. TT-D3008B
SCALE 1" = 5'
SHEET NO.

Exhibit B

Project Drawings

Exhibit B4 – Guideway Drawings

Exhibit B4-3.1 – Avenue 7 Gdwy Plan & Profile

Exhibit B4-3.2 – Avenue 8 Gdwy Plan & Profile

Exhibit B4-3.3 – Avenue 9 Gdwy Plan & Profile

Exhibit B4-3.4 – Avenue 10 Gdwy Plan & Profile

Exhibit B4-3.5 – Avenue 11 Gdwy Plan & Profile

Exhibit B4-3.6 – Avenue 12 HST Gdwy Plan & Profile

10/20/2015 4:50:52 PM CHSTP.tbl CHSR_PDF_half_black.plt c:\pwworking\cadot\p004863a\dms07895\TT-D1043.dgn

p004863a

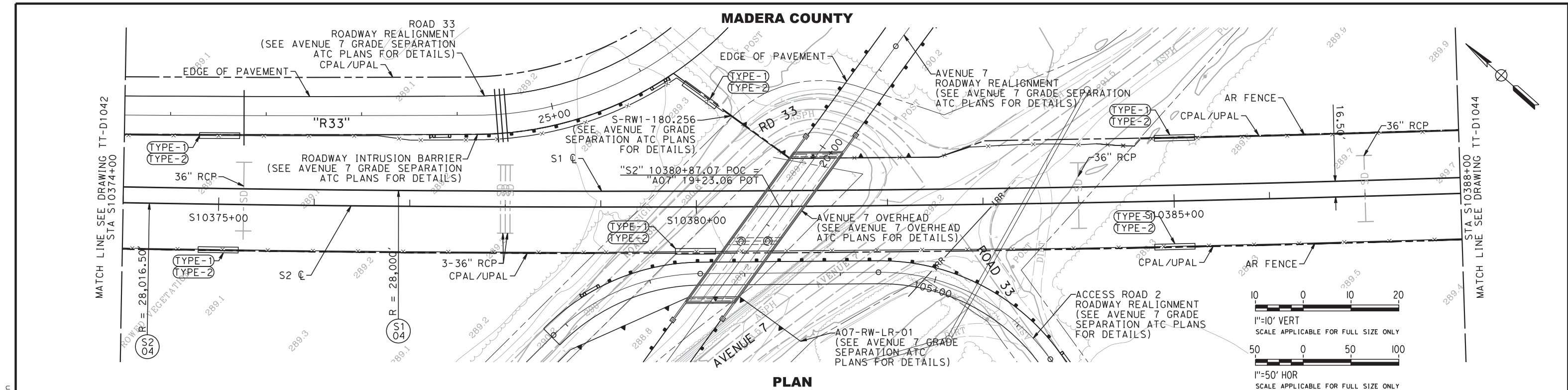

PLAN

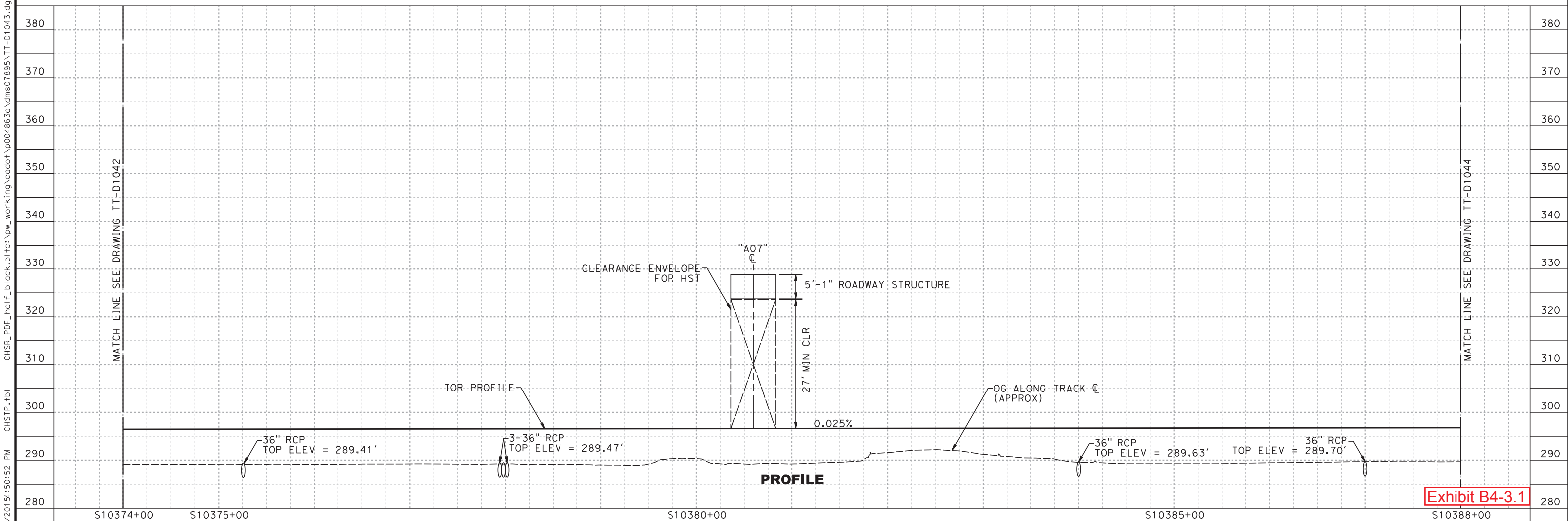

PROFILE

10/2/15

0048630

F	11/03/15				90% GUIDEWAY STA 10304+00.00 TO 10691+50.00	DESIGNED BY A. SOBOLEWSKA	90% SUBMITTAL NOT FOR CONSTRUCTION	CALIFORNIA HIGH-SPEED TRAIN PROJECT CP-1 AGREEMENT NO.4 HSR13-06 SUBMITTAL REVIEW IN ACCORDANCE WITH BOOK 2, PART B - GENERAL PROVISIONS - SECTION 61.2	APPROVED SIGNED _____ DATE _____	   <i>A joint venture</i>	 <i>CALIFORNIA HIGH-SPEED RAIL AUTHORITY</i>	CALIFORNIA HIGH-SPEED TRAIN PROJECT CONSTRUCTION PACKAGE 1 TRACK GUIDEWAY STA S10374+00 TO S10388+00 PLAN AND PROFILE				CONTRACT NO. HSR13-06
E	08/25/15				DESIGN BASELINE REPORT PART 5 REV 1	DRAWN BY A. SOBOLEWSKA										DRAWING NO. TT-D1043
D	03/19/15				DESIGN BASELINE REPORT PART 5 REV 0	CHECKED BY A. FERNANDEZ										SCALE AS SHOWN
C	10/24/14				60% GUIDEWAY STA 10304+00.00 TO 10691+50.00	IN CHARGE S. GOOLLA										SHEET NO.
B	07/11/14				DESIGN BASELINE REPORT	DATE 11/03/2015										
REV	DATE	BY	CHK	APP	DESCRIPTION											

Exhibit B4-3.1



PLAN

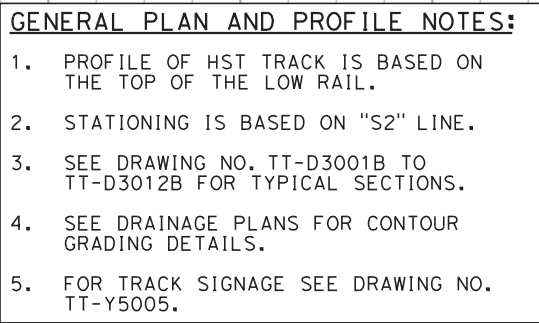

PROFILE

CALIFORNIA HIGH-SPEED TRAIN PROJECT CONSTRUCTION PACKAGE 1

TRACK GUIDEWAY
STA S10304+00 TO S10318+00
PLAN AND PROFILE

CONTRACT NO.	HSR13-06
DRAWING NO.	TT-D1038
SCALE	AS SHOWN
SHEET NO.	

10/20/2015 4:49:33 PM CHSTP.tbl CHSR_PDF_half_black.plt c:\pwworking\cdot\p004863a\dms07895\TT-D1039.dgn

p004863a

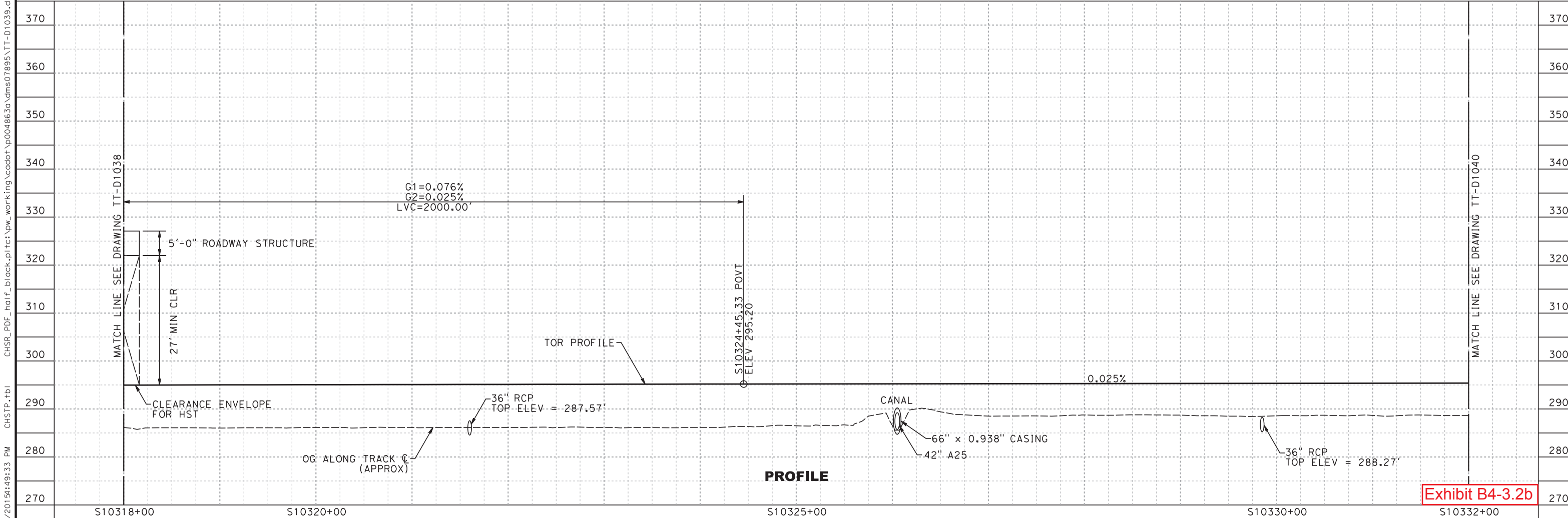
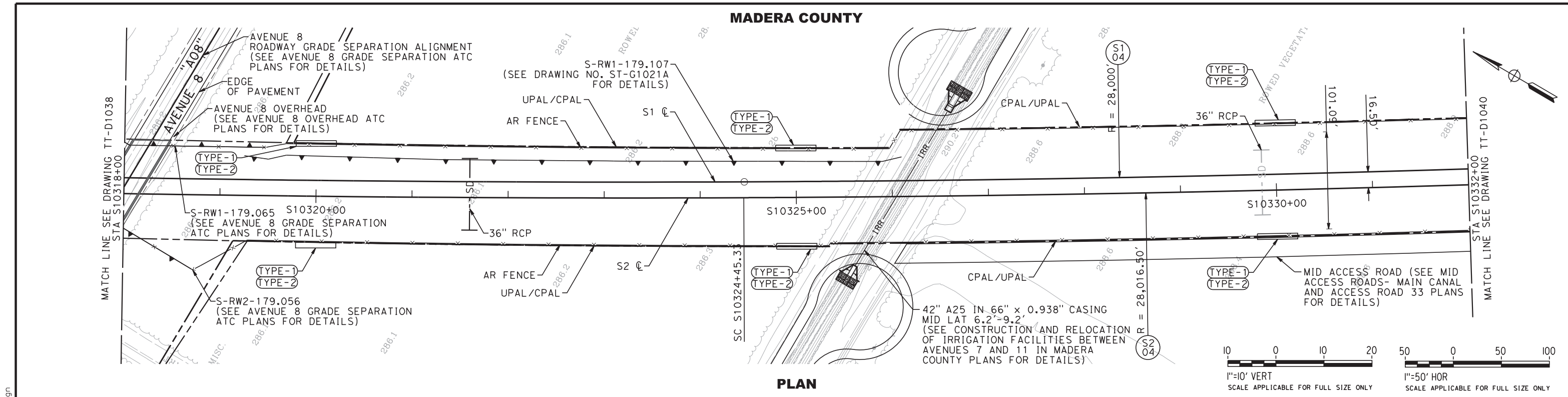

10/2/2015	F	11/03/15				90% GUIDEWAY STA 10304+00.00 TO 10691+50.00	DESIGNED BY A. SOBOLEWSKA	90% SUBMITTAL <
-----------	---	----------	--	--	--	---	------------------------------	--

1/25/2015 9:12:43 PM CHSTP.tbl CHSR_PDF_half_black.plt c:\pwworking\california\p005136a\dms07895\TT-D1034.dgn p005136a

MADERA COUNTY

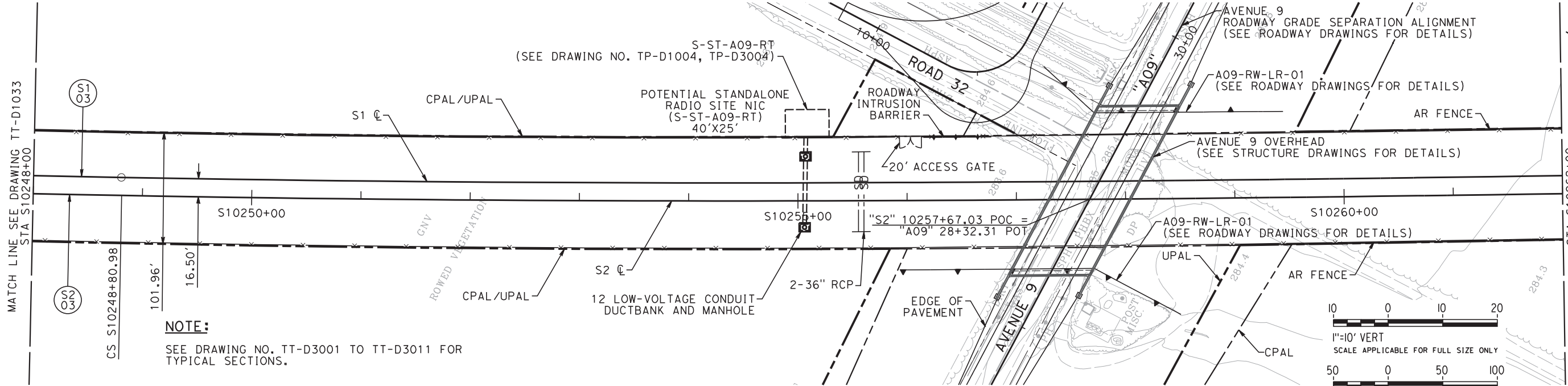

PLAN

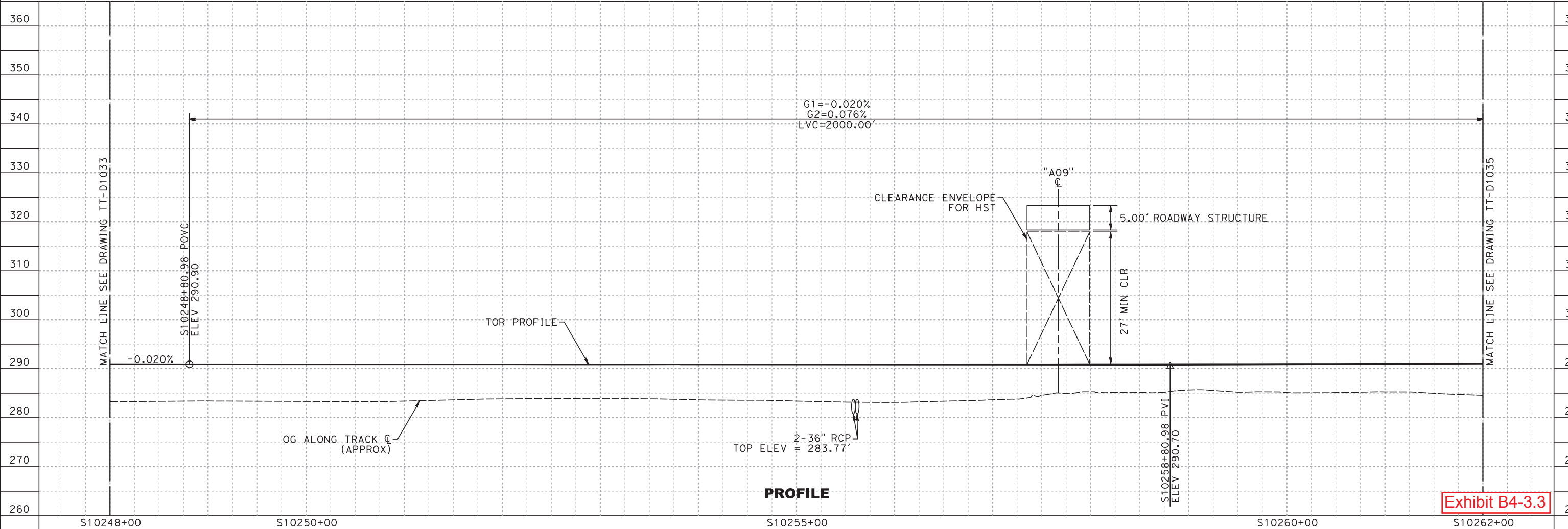

PROFILE

Exhibit B4-3.3

REV	DATE	BY	CHK	APP	DESCRIPTION
C	01/30/15				90% GUIDEWAY STA 9772+35.08 TO 10304+00.00
B	09/29/14				60% GUIDEWAY STA 9772+35.08 TO 10304+00.00
A	06/23/14				DESIGN BASELINE REPORT

DESIGNED BY A. FERNANDEZ
DRAWN BY A. SOBOLEWSKA
CHECKED BY E. CASTELINO
IN CHARGE S. GOOLLA
DATE 01/30/2015

90% SUBMITTAL

NOT FOR
CONSTRUCTION



**CALIFORNIA HIGH-SPEED TRAIN PROJECT
CONSTRUCTION PACKAGE 1**

TRACK GUIDEWAY
STA S10248+00 TO S10262+00
PLAN AND PROFILE

CONTRACT NO. HSR13-06
DRAWING NO. TT-D1034
SCALE AS SHOWN
SHEET NO.

1/25/2015 9:05:01 PM CHSTP.tbl CHSR_PDF_half_black.plt c:\pwworking\california\p005136a\dms07895\TT-D1026.dgn

p005136a

MADERA COUNTY

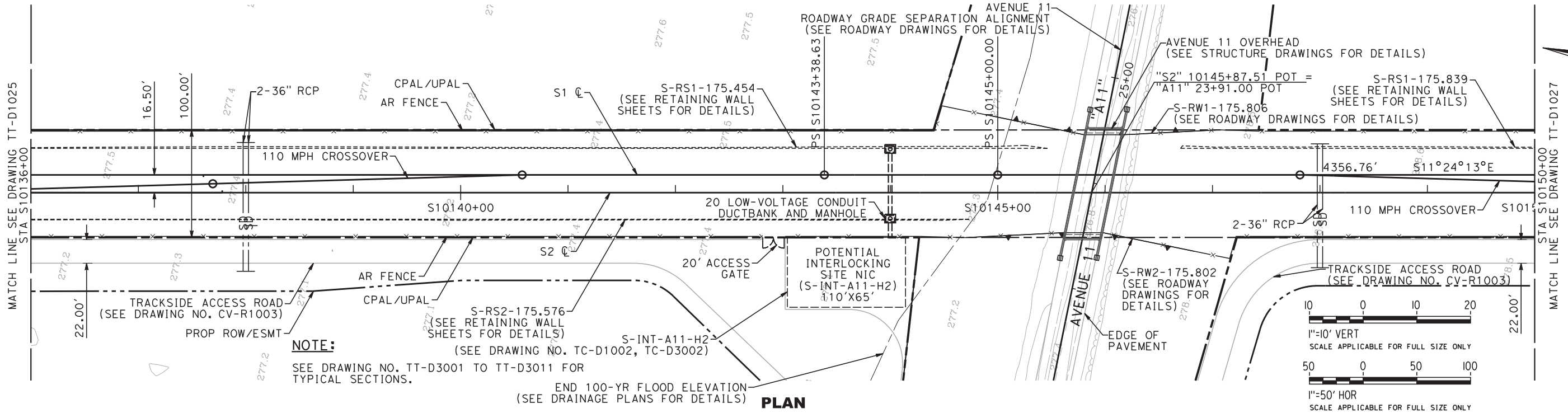

PLAN

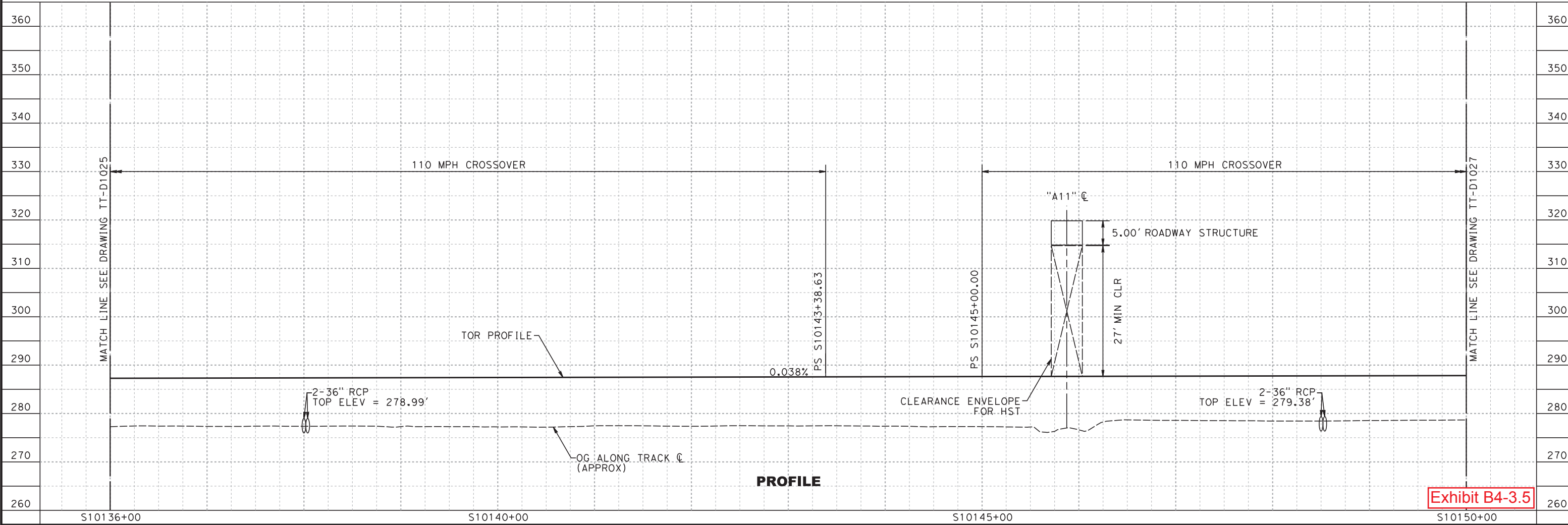

PROFILE

Exhibit B4-3.5

REV	DATE	BY	CHK	APP	DESCRIPTION
C	01/30/15				90% GUIDEWAY STA 9772+35.08 TO 10304+00.00
B	09/29/14				60% GUIDEWAY STA 9772+35.08 TO 10304+00.00
A	06/23/14				DESIGN BASELINE REPORT

DESIGNED BY A. FERNANDEZ
DRAWN BY A. SOBOLEWSKA
CHECKED BY E. CASTELINO
IN CHARGE S. GOOLLA
DATE 01/30/2015

90% SUBMITTAL

NOT FOR
CONSTRUCTION



CALIFORNIA HIGH-SPEED TRAIN PROJECT
CONSTRUCTION PACKAGE 1

TRACK GUIDEWAY
STA S10136+00 TO S10150+00
PLAN AND PROFILE

CONTRACT NO. HSR13-06
DRAWING NO. TT-D1026
SCALE AS SHOWN
SHEET NO.

1/25/2015 9:01:08 PM CHSTP.tbl CHSR_PDF_half_black.plt c:\pwworking\california\p005136a\dms07895\TT-D1022.dgn p005136a

MADERA COUNTY

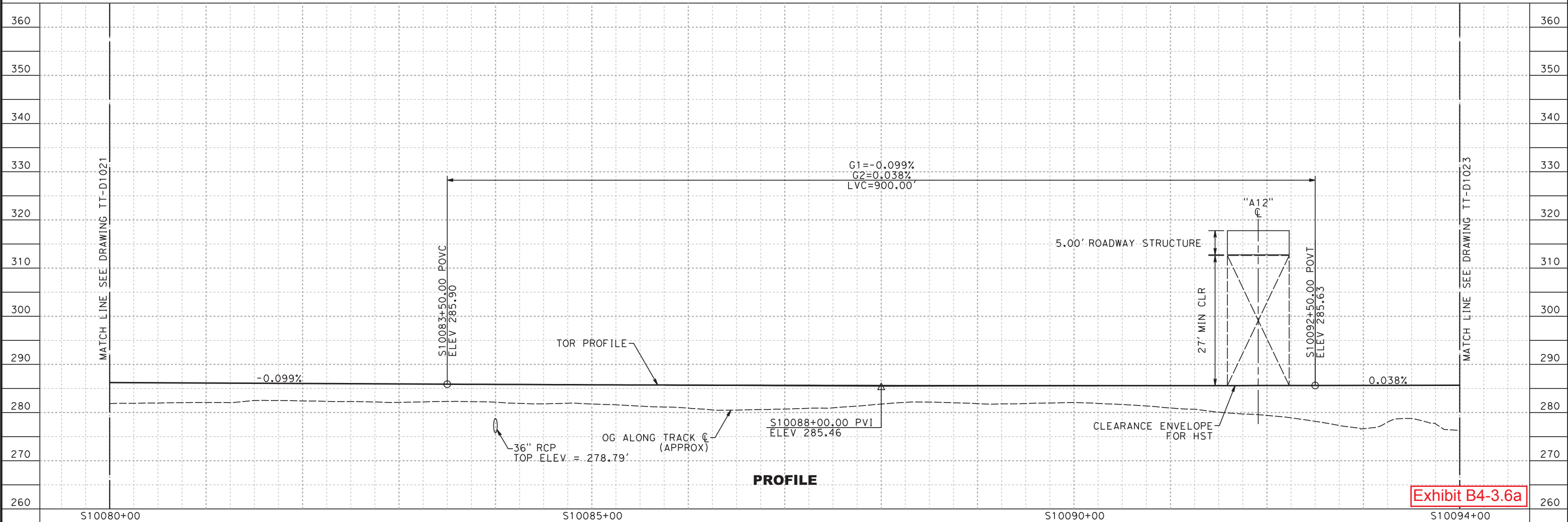
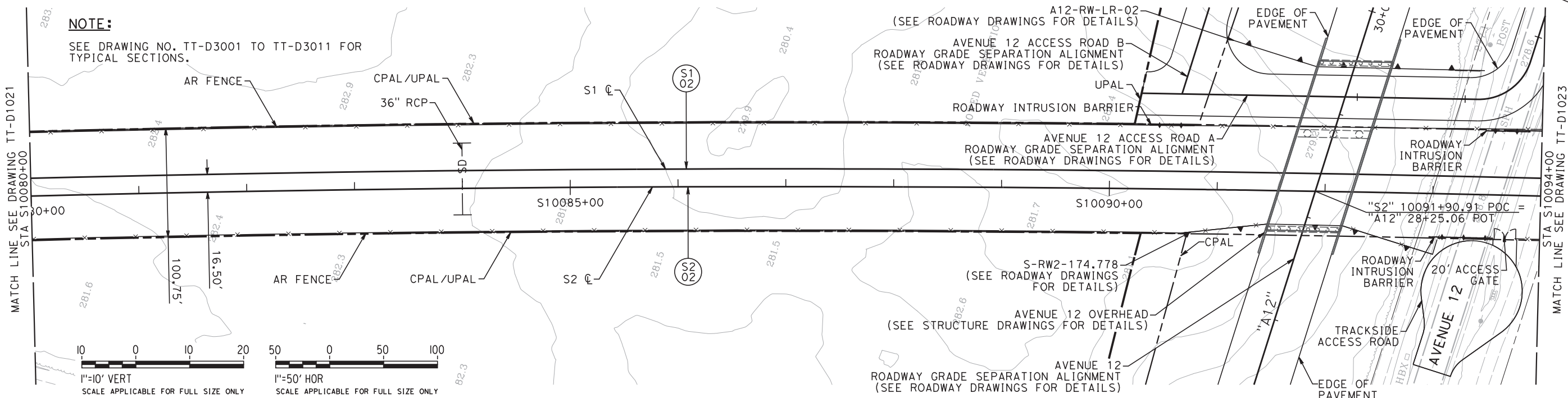

Exhibit B4-3.6a

REV	DATE	BY	CHK	APP	DESCRIPTION
C	01/30/15				90% GUIDEWAY STA 9772+35.08 TO 10304+00.00
B	09/29/14				60% GUIDEWAY STA 9772+35.08 TO 10304+00.00
A	06/23/14				DESIGN BASELINE REPORT

DESIGNED BY A. FERNANDEZ
DRAWN BY A. SOBOLEWSKA
CHECKED BY E. CASTELINO
IN CHARGE S. GOOLLA
DATE 01/30/2015

90% SUBMITTAL

NOT FOR
CONSTRUCTION

TutorPerini

ZACHRY

PARSONS

A joint venture



CALIFORNIA
HIGH-SPEED RAIL AUTHORITY

CALIFORNIA HIGH-SPEED TRAIN PROJECT
CONSTRUCTION PACKAGE 1

TRACK GUIDEWAY
STA S10080+00 TO S10094+00
PLAN AND PROFILE

CONTRACT NO. HSR13-06
DRAWING NO. TT-D1022
SCALE AS SHOWN
SHEET NO.

1/25/2015 9:02:12 PM CHSTP.tbl CHSR_PDF_half_black.plt c:\pwworking\california\p005136a\dms07895\TT-D1023.dgn

p005136a

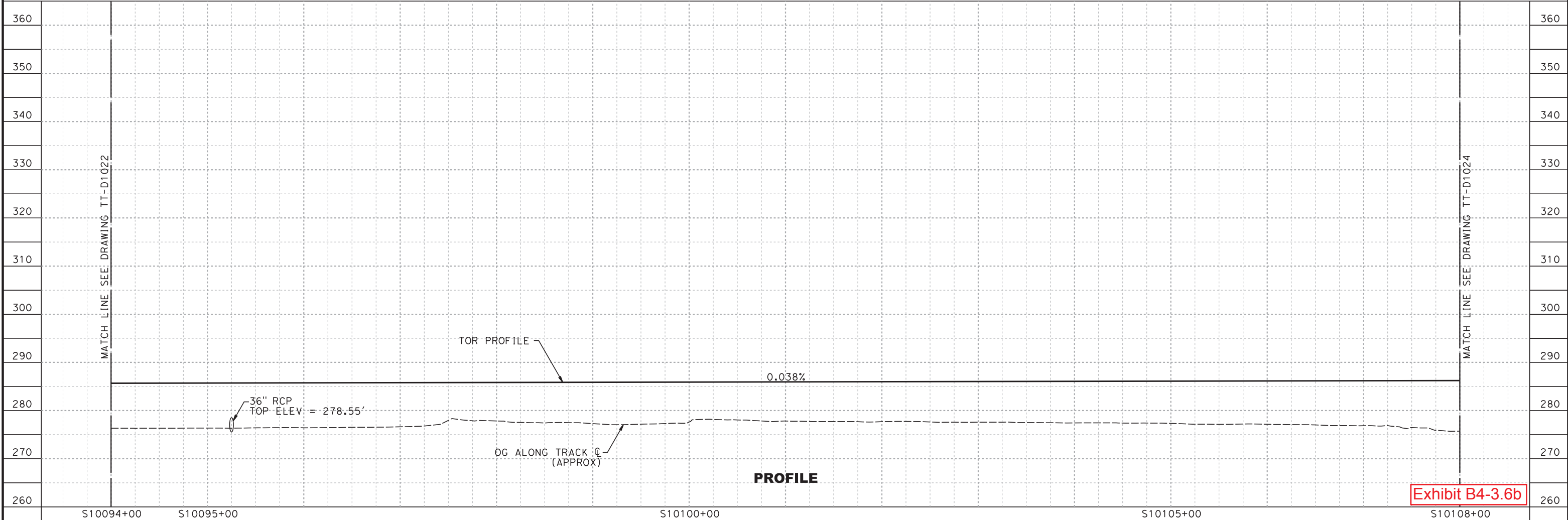
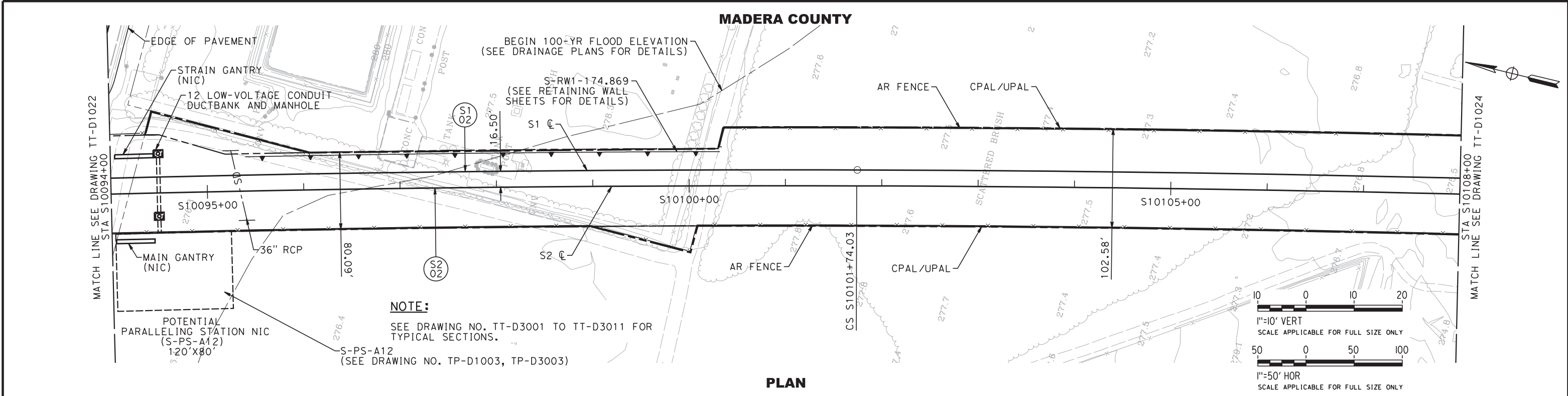

						DESIGNED BY A. FERNANDEZ	90% SUBMITTAL	   A joint venture	 CALIFORNIA HIGH-SPEED RAIL AUTHORITY	CALIFORNIA HIGH-SPEED TRAIN PROJECT CONSTRUCTION PACKAGE 1 TRACK GUIDEWAY STA S10094+00 TO S10108+00 PLAN AND PROFILE	CONTRACT NO. HSR13-06
C	01/30/15				90% GUIDEWAY STA 9772+35.08 TO 10304+00.00	DRAWN BY A. SOBOLEWSKA					DRAWING NO. TT-D1023
B	09/29/14				60% GUIDEWAY STA 9772+35.08 TO 10304+00.00	CHECKED BY E. CASTELINO					SCALE AS SHOWN
A	06/23/14				DESIGN BASELINE REPORT	IN CHARGE S. GOOLLA					SHEET NO.
REV	DATE	BY	CHK	APP	DESCRIPTION	DATE 01/30/2015					